

# 4.11

## Ex-Pendant light fittings and floodlights of the series VMV LED

4 (Zone 2, 21, 22)

### The powerful floodlight with LED technology VMV LED 3/5/7/9/11L

The energy-saving VMV pendant light fittings and floodlights with LED technology are ideal for all general lighting applications in hazardous areas in Zone 2 and hazardous dust areas in Zones 21 and 22. With the integrated high-power LED technology, these lights can be used to replace comparable conventional light sources with an equivalent capacity of up to 1000W.

### LED technology for heavy-duty use

Due to the particularly solid construction of the housing and the vibration resistance of the LED module, the VMV floodlight is resistant to impact, shock and vibration. As a result, it represents the ideal lighting concept for use in areas with difficult environmental conditions. Thanks to the non-sensitive LED technology, even extreme temperatures from -40 °C up to +65 °C are not a problem. The robust, powder-coated light metal housing in the degree of protection

IP66 and the impact-resistant lens meet the highest corrosion protection and mechanical resistance requirements. The advantages of the integrated, advanced LED technology with a high luminous flux and, at the same time, an extremely low energy consumption are a long service life and a high level of efficiency. With a power consumption of 29 W to 232 W, it is ideal for replacing 70 W to 1000 W light fittings with high pressure lamps.

### The best lighting technology for every application

The VMV LED pendant light fittings and floodlights series are available with 3 different custom optics:



Type V has a symmetric light distribution and is optimized for general area illumination.



Type III has an asymmetrical light distribution and is, therefore, suitable for near-edge mounting (wall mounting) for surface illumination



Type I has a narrow light distribution and is ideal for lighting roads and pathways.

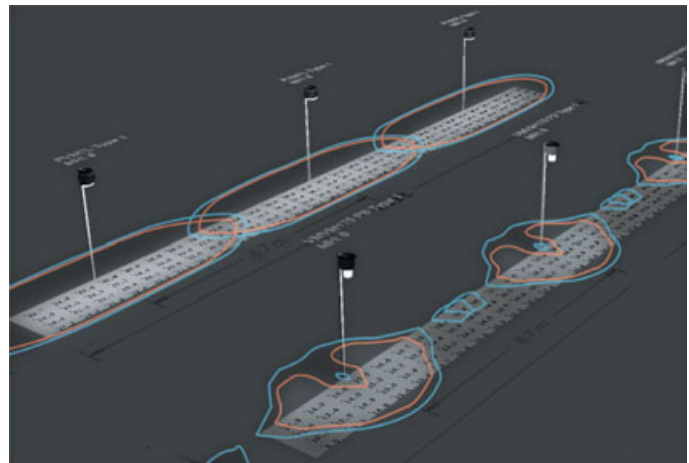



Champ VMV with Type I optics (left row) compared to conventional fixtures (on the right)

### Features

- High power LED modules
- Multiple drivers
- High efficient heat sink design for optimized thermal management
- Wide temperature range according to type from -40 °C up to +65 °C
- High degree of protection IP66 for harsh environments

### Ordering details

Type	Lamp / Illuminant	Rated luminous flux of the luminaire	Weight	Cable gland/ thread	Screw plugs	Enclosure type	Order No.
<b>VMV LED lamp module with LEDs (without top mounting module, please order separately)</b>							
 Enclosure type 1	VMV LED 3L	29 W Typ V	3515 lm	8.1 kg	–	1	<b>1 2364 745</b>
	VMV LED 5L	43 W Typ V	5335 lm	8.1 kg	–	1	<b>1 2364 746</b>
	VMV LED 7L	55 W Typ V	7260 lm	8.1 kg	–	1	<b>1 2365 201</b>
	VMV LED 9L	85 W Typ V	9226 lm	8.1 kg	–	1	<b>1 2365 202</b>
	VMV LED 11L	113 W Typ V	11440 lm	8.1 kg	–	1	<b>1 2396 576</b>
	VMV LED 13L	130 W Type V	13266 lm	16.3 kg	–	2	<b>1 2442 415</b>
 Enclosure type 2	VMV LED 17L	168 W Type V	18793 lm	16.3 kg	–	2	<b>1 2442 952</b>
	VMV LED 21L	196 W Type V	22110 lm	20.0 kg	–	3	<b>1 2442 986</b>
	VMV LED 25L	232 W Type V	26531 lm	20.0 kg	–	3	<b>1 2443 020</b>
	VMV LED 3L	29 W Typ I	3360 lm	8.1 kg	–	1	<b>1 2374 698</b>
 Enclosure type 3	VMV LED 5L	43 W Typ I	5045 lm	8.1 kg	–	1	<b>1 2375 046</b>
	VMV LED 7L	55 W Typ I	6844 lm	8.1 kg	–	1	<b>1 2375 106</b>
	VMV LED 9L	85 W Typ I	8823 lm	8.1 kg	–	1	<b>1 2375 186</b>
	VMV LED 11L	113 W Typ I	10730 lm	8.1 kg	–	1	<b>1 2401 259</b>
	VMV LED 13L	130 W Type I	12842 lm	16.3 kg	–	2	<b>1 2442 930</b>
	VMV LED 17L	168 W Type I	18195 lm	16.3 kg	–	2	<b>1 2442 963</b>
	VMV LED 21L	196 W Type I	21404 lm	20.0 kg	–	3	<b>1 2442 997</b>
	VMV LED 25L	232 W Type I	25685 lm	20.0 kg	–	3	<b>1 2443 031</b>
	VMV LED 3L	29 W Typ III	3309 lm	8.1 kg	–	1	<b>1 2374 782</b>
	VMV LED 5L	43 W Typ III	4468 lm	8.1 kg	–	1	<b>1 2375 047</b>
	VMV LED 7L	55 W Typ III	6741 lm	8.1 kg	–	1	<b>1 2375 107</b>
	VMV LED 9L	85 W Typ III	8618 lm	8.1 kg	–	1	<b>1 2375 187</b>
VMV LED 11L	113 W Typ III	10660 lm	8.1 kg	–	1	<b>1 2402 998</b>	
VMV LED 13L	130 W Type III	12493 lm	16.3 kg	–	2	<b>1 2442 941</b>	
VMV LED 17L	168 W Type III	17699 lm	16.3 kg	–	2	<b>1 2442 974</b>	
VMV LED 21L	196 W Type III	20822 lm	20.0 kg	–	3	<b>1 2442 909</b>	
VMV LED 25L	232 W Type III	24987 lm	20.0 kg	–	3	<b>1 2443 042</b>	
Type	Content	Weight	Cable gland/ thread	Screw plugs	Order No.		

### VMV LED top mounting module, (without lamp module, please order separately)

JM5	top mounting module for 1 1/2" pole mounting, 25°	1.6 kg	1 x 3/4" thread	–	<b>22 250</b>
PM5	top mounting module for 1 1/2" pole mounting, straight	2.5 kg	1 x 3/4" thread	–	<b>00 080</b>
CM20	top mounting module with M20 ceiling mounting	1.3 kg	4 x M20 thread	4 x M20	<b>1 1843 088</b>
TWM20	top mounting module with M20 wall mounting	2.0 kg	4 x M20 thread	4 x M20	<b>1 1832 237</b>
S812	mounting bracket (can only be used with top mounting module CM20)	1.0 kg	–	–	<b>1 2268 927</b>
JGA5520	Pole adapter for M20 cable gland (JM5/PM5)	0.45 kg	1 1/2" NPT pole thread, 1 x M20 thread		<b>1 1826 774</b>
JGA5525	Pole adapter for M25 cable gland (JM5/PM5)	0.45 kg	1 1/2" NPT pole thread, 1 x M25 thread		<b>1 1826 777</b>

# 4.11

## Polar curve / Dimension drawing

VMV LED

**Polar curve VMV LED Type V**

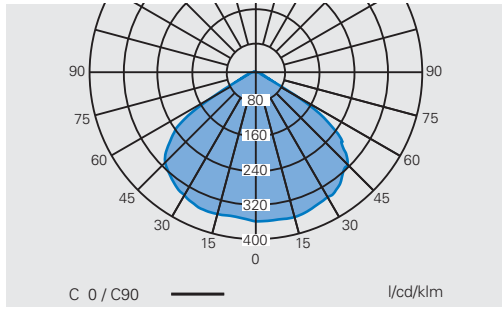

**Polar curve VMV LED Type I**

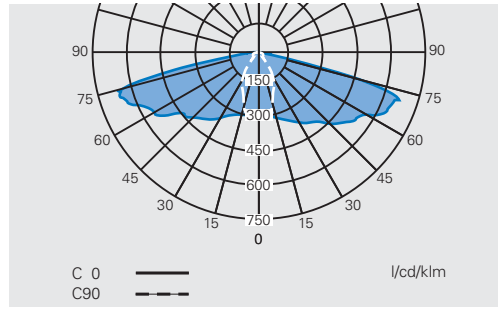

**Polar curve VMV LED Type III**

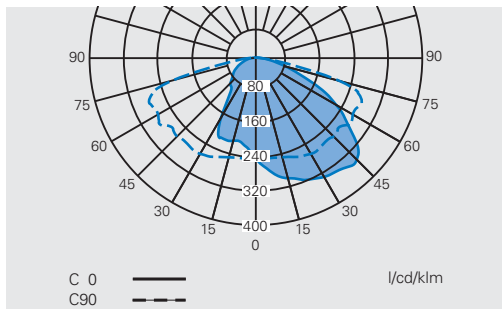

### VMV LED

**with top mounting module JM5**

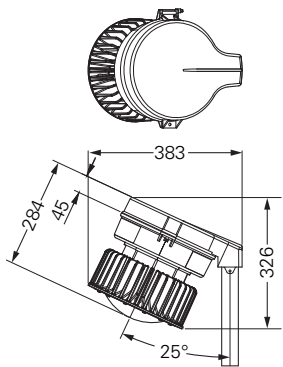

**with top mounting module PM5**

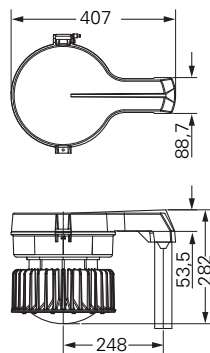

**with top mounting module CM25**

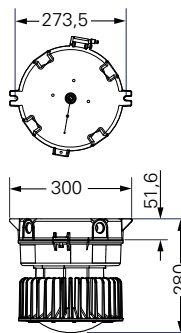

**with top mounting module TWM25**

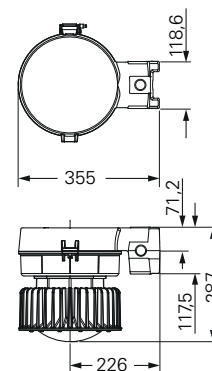

**Mounting bracket S812**

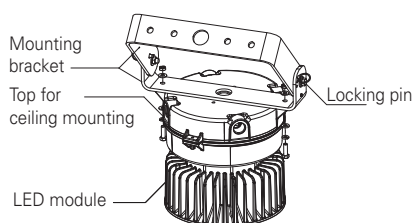

**Pole adapter JGA5520 / JGA5525**

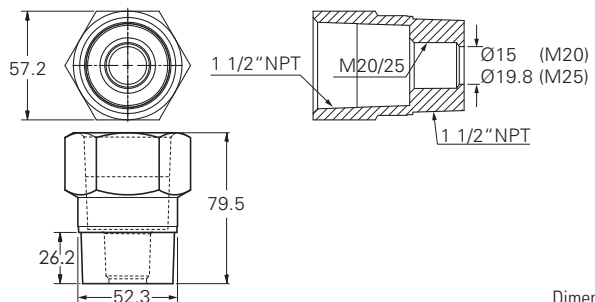

Dimensions in mm



Technical data

4

	VMV LED 3L - 11L	VMV LED 13L - 17L	VMV LED 20L - 25L
Type Examination Certificate (gas)	DEMKO 13 ATEX 1305741X	DEMKO 14 ATEX 1324722X	DEMKO 14 ATEX 1324722X
EC-Type Examination Certificate (dust)	DEMKO 13 ATEX 1475031X	DEMKO 14 ATEX 2274231X	DEMKO 14 ATEX 2274231X
IECEX Certificate of Conformity	IECEX UL 13.0052X	IECEX UL 14.0031X	IECEX UL 14.0031X
Marking accd. to 94/9/EC	⊕ II 3 G Ex nA nR IIC T6/T5 Gc ⊕ II 2 D Ex tb IIIC T92/T87/72°C Db IP66	⊕ II 3 G Ex nA nR IIC T6/T5 Gc ⊕ II 2 D Ex tb IIIC T87/72°C Db IP66	⊕ II 3 G Ex nA nR IIC T6/T5 Gc ⊕ II 2 D Ex tb IIIC T87/72°C Db IP66
Marking accd. to IECEx	Ex nA nR IIC T6 Gc / Ex tb IIIC T87°C/T72 °C Db IP66	Ex nA nR IIC T6/T5 Gc / Ex tb IIIC T81°C/T66 °C Db IP66	Ex nA nR IIC T6/T5 Gc / Ex tb IIIC T86°C/T71 °C Db IP66
Permissible ambient temperature	-40 °C up to +65 °C	-40 °C up to +55 °C	-40 °C up to +55 °C
Lifetime fixture	200,000 h at t <sub>a</sub> = +25 °C 60,000 h at t <sub>a</sub> = +65 °C	170,000 h at t <sub>a</sub> = +25 °C 60,000 h at t <sub>a</sub> = +55 °C	170,000 h at t <sub>a</sub> = +25 °C 60,000 h at t <sub>a</sub> = +55 °C
Rated voltage	120 - 277 V AC / 108 - 250 V DC	100 - 277 V AC / 108 - 250 V DC	100 - 277 V AC / 108 - 250 V DC
Frequency	50 - 60 Hz	50 - 60 Hz	50 - 60 Hz
Power	<sup>1)</sup>	<sup>1)</sup>	<sup>1)</sup>
Power factor cos φ	> 0.9	> 0.9	> 0.9
Circuit	electronic driver	electronic driver	electronic driver
Protection class	I	I	I
Lamp / Illuminant	LED System, scope of delivery	LED System, scope of delivery	LED System, scope of delivery
Light colour/CRI	5000 K/70, 3000 K/80 on request	5000 K/70, 3000 K/80 on request	5000 K/70, 3000 K/80 on request
Rated luminous flux of the luminaire	<sup>1)</sup>	<sup>1)</sup>	<sup>1)</sup>
Dimensions (L x W x H)	280 x 295 x 230 mm	381 x 381 x 197 mm	381 x 381 x 274 mm
Connecting terminals	L, N, PE max. 2 x 2.5 mm <sup>2</sup>	L, N, PE max. 2 x 2.5 mm <sup>2</sup>	L, N, PE max. 2 x 2.5 mm <sup>2</sup>
Enclosure colour	grey/black	grey/black	grey/black
Enclosure material	Copper-free aluminium with epoxy-powder coating	Copper-free aluminium with epoxy-powder coating	Copper-free aluminium with epoxy-powder coating
Weight	8.1 kg	16.3 kg	20.0 kg
Degree of protection accd. to EN 60529	IP66	IP66	IP66
Protective cover / protective bowl	Heat- and impact-resistant glass <sup>2)</sup>	Heat- and impact-resistant glass <sup>2)</sup>	Heat- and impact-resistant glass <sup>2)</sup>

<sup>1)</sup> see table luminaire data

<sup>2)</sup> Polycarbonate lens on request

Additional luminaire data

Type	Power	luminous flux of the luminaire type V	Temperature class II 3 G			max. surface temp. II 2 D		
			TU ≤ 40 °C	TU ≤ 55 °C	TU ≤ 65 °C	TU ≤ 40 °C	TU ≤ 55 °C	TU ≤ 65 °C
<b>VMV LED</b>								
VMV 3L LED	29 W	3515 lm	T6	T5	T4	T72 °C	T87 °C	T92 °C
VMV 5L LED	43 W	5335 lm	T6	T5	T4	T72 °C	T87 °C	T92 °C
VMV 7L LED	55 W	7260 lm	T6	T5	T4	T72 °C	T87 °C	T92 °C
VMV 9L LED	85 W	9226 lm	T6	T5	T4	T72 °C	T87 °C	T92 °C
VMV 11L LED	113 W	11440 lm	T6	T5	T4	T72 °C	T87 °C	T92 °C
VMV 13L LED	131 W	13226 lm	T6	T5		T66 °C	T81 °C	
VMV 17L LED	168 W	18793 lm	T6	T5		T66 °C	T81 °C	
VMV 20L LED	196 W	22110 lm	T6	T5		T71 °C	T86 °C	
VMV 25L LED	232 W	26531 lm	T6	T5		T71 °C	T86 °C	