

32A 4-pole up to 690 V

32A 5-pole up to 415 V



Wall socket



Flange socket



Coupler



Plug

## Technical data

### Ex-plugs and receptacles acc. to IEC 60309-1/2

Marking accd. to 94/9/EC	Ex II 2 G Ex de (ia) IIC T6 / Ex II 2 D Ex tD A21 IP66 T80 °C
EC-Type Examination Certificate	Wall socket, plug and coupler: PTB 99 ATEX 1041 Flange socket: PTB 99 ATEX 1042 U
IECEX Certificate of Conformity	IECEX BKI 04.0006
Marking accd. to IECEx	Ex ed [ia] IIC T6/T5
Permissible ambient temperature	-20 °C to +40 °C <sup>1)</sup>
Rated voltage	up to 690 V (AC)
Rated current	32 A
Frequency	up to 400 Hz
Rated making / Rated breaking capacity AC-3 accd. EN 60947-3	U <sub>0</sub> 690 V / I <sub>0</sub> 32 A
External back up fuse	without therm. protection: 35 A with therm. protection: 50 A gL (rated current 32 A set to)
Protection class	I
Degree of protection accd. to EN 60529	IP66
Enclosure colour	black

#### Wall socket

Cable entry/enclosure drilling	1 x M40 Ø 17 - 28 mm, 1 x M40 plastic Ex-screw plug or 2 x M32 metal thread with 2 plastic Ex-screw plug
Connecting terminals	2 x 4 - 10 mm <sup>2</sup>
Enclosure material	glass-fibre reinforced polyester

#### Plug

Cable entry	Ø 17 - 28 mm
Connecting terminals	1.0 - 6 mm <sup>2</sup>
Enclosure material	Polyamide

#### Coupler

Cable entry	Ø 17 - 28 mm
Connecting terminals	2 x 4 - 10 mm <sup>2</sup>
Enclosure material	Polyamide

#### Flange socket

Connecting terminals	2 x 4 - 10 mm <sup>2</sup>
Enclosure material	Polyamide

1) extended temperature range on request



## Ordering details

Voltage	h	Type	Aux. contact	Cable entry	Weight approx.	Order No.
<b>Type 32 A 4-pole</b>						
200-250 V		Wall socket	–	KU	1.8 kg	<b>GHG 512 4409 R0001</b>
		Wall socket	–	ME	1.9 kg	<b>GHG 512 4409 R3001</b>
		Wall socket	–	GM	2.0 kg	<b>GHG 512 4409 R3003</b>
		Flange socket			1.0 kg	<b>GHG 512 8409 R0001</b>
		Coupler			1.7 kg	<b>GHG 512 3409 R0001</b>
380-415 V	9 h	Plug			0.7 kg	<b>GHG 512 7409 R0001</b>
		Wall socket	–	KU	1.8 kg	<b>GHG 512 4406 R0001</b>
		Wall socket	–	ME	1.9 kg	<b>GHG 512 4406 R3001</b>
		Wall socket	yes	KH	1.8 kg	<b>GHG 512 4406 R0501</b>
		Wall socket	–	GM	2.0 kg	<b>GHG 512 4406 R3003</b>
480-500 V	6 h	Flange socket			1.0 kg	<b>GHG 512 8406 R0001</b>
		Coupler			1.7 kg	<b>GHG 512 3406 R0001</b>
		Plug			0.7 kg	<b>GHG 512 7406 R0001</b>
		Wall socket	–	KU	1.8 kg	<b>GHG 512 4407 R0001</b>
		Wall socket	–	ME	1.9 kg	<b>GHG 512 4407 R3001</b>
600-690 V	7 h	Wall socket	yes	KH	1.8 kg	<b>GHG 512 4407 R0501</b>
		Flange socket			1.0 kg	<b>GHG 512 8407 R0001</b>
		Coupler			1.7 kg	<b>GHG 512 3407 R0001</b>
		Plug			0.7 kg	<b>GHG 512 7407 R0001</b>
		Wall socket	–	KU	1.8 kg	<b>GHG 512 4405 R0001</b>
380-415 V	5 h	Wall socket	–	ME	1.9 kg	<b>GHG 512 4405 R3001</b>
		Wall socket	yes	KH	1.8 kg	<b>GHG 512 4405 R0501</b>
		Flange socket			1.0 kg	<b>GHG 512 8405 R0001</b>
		Coupler			1.7 kg	<b>GHG 512 3405 R0001</b>
		Plug			0.7 kg	<b>GHG 512 7405 R0001</b>
		Wall socket	–	GM	2.0 kg	<b>GHG 512 4506 R3003</b>
<b>Type 32 A 5-pole</b>						
200-250 V		Wall socket	–	KU	1.8 kg	<b>GHG 512 4506 R0001</b>
380-415 V		Wall socket	–	ME	1.9 kg	<b>GHG 512 4506 R3001</b>
		Wall socket	yes	KH	1.8 kg	<b>GHG 512 4506 R0501</b>
		Wall socket	–	GM	2.0 kg	<b>GHG 512 4506 R3003</b>
		Flange socket			1.0 kg	<b>GHG 512 8506 R0001</b>
		Coupler			1.7 kg	<b>GHG 512 3506 R0001</b>
Plug			0.7 kg	<b>GHG 512 7506 R0001</b>		

Other voltage ranges and versions available on request

KU = 1 x plastic cable glands M40 for Ø 17-28 mm, 1 x M40 plastic Ex-screw plug

KH = 1 x plastic cable glands M40 for Ø 17-28 mm,

1 x plastic cable glands M25 for Ø 8 - 17 mm, with aux. contact

ME = 2 x metal thread M32 with plastic Ex-screw plug

GM = 2 x metal thread M32 with screw plug, with external earth bolt M6

32A 4-pole up to 690 V

32A 5-pole up to 415 V



Wall socket



Flange socket



Coupler



Plug

Dimension drawing | Wiring diagram

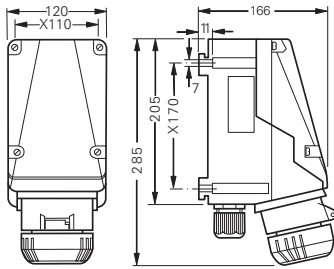

Wall socket 4-pole

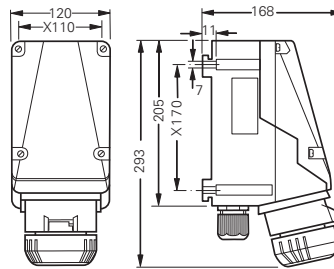

Wall socket 5-pole

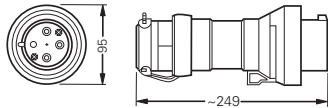

Plug 4-pole

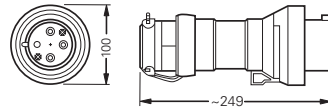

Plug 5-pole

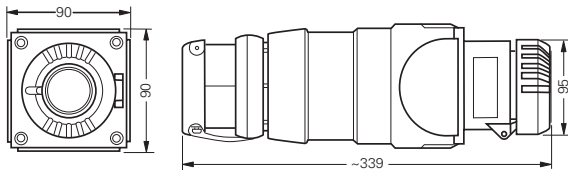

Coupler 4-pole

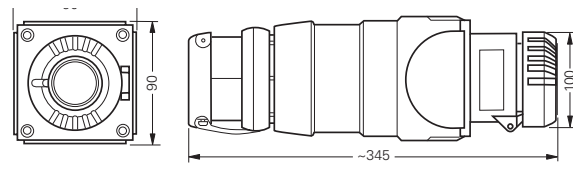

Coupler 5-pole

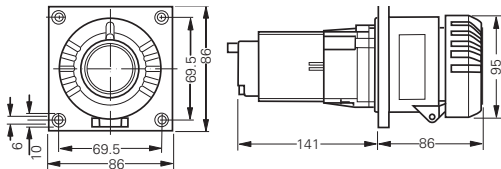

Flange socket 4-pole

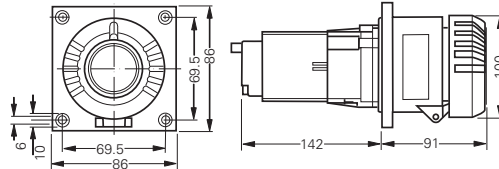

Flange socket 5-pole

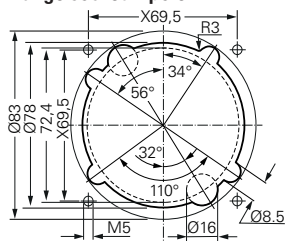

Assembly dimensions flange socket

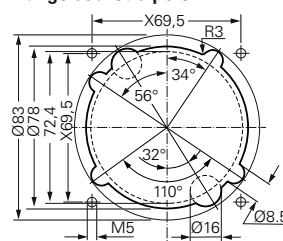

Assembly dimensions flange socket

X = fixing dimensions

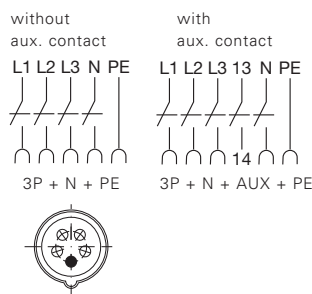
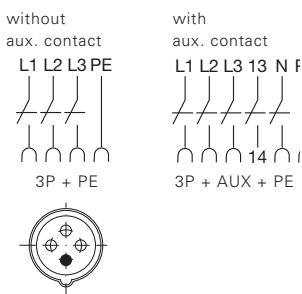

Dimensions in mm

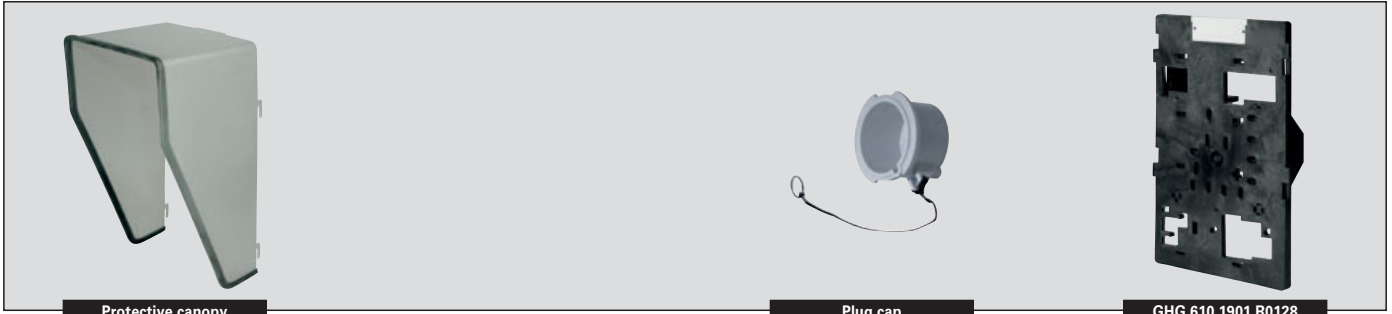

Protective canopy

Plug cap

GHG 610 1901 R0128

## Accessories

### Mounting plates for wall sockets 32 A

Type	Application	Fixing method	Order No.
Size 5	for wall mounting	snap on	GHG 610 1953 R0128
Size 5	for trellis mounting	snap on	GHG 610 1953 R0128
Size 5	for pipe clamp	snap on	GHG 610 1953 R0132

### Plug cap for plugs 32 A

Type	Order No.
Plug 32 A 3-pole/4-pole	GHG 510 1901 R0004
Plug 32 A 5-pole	GHG 510 1901 R0005

### Accessories for mounting plates

Type	OU	Order No.
Mounting set for pipes 1" (Ø 27 - 30 mm) for mounting plates with pipe fixing	10	GHG 610 1953 R0020

Please pay attention that only order units (OU) according to the ordering details can be delivered.

### Protective canopy for mounting plate

Type	Application	Order No.
Size 5	for mounting plate size 5, snap on	GHG 610 1955 R0108

## Dimension drawing

